

Ms Ezgi Bolat
Licensing Consultant
55 Stoke Newington High Street
Hackney
N16 8EL

Please reply to Ellie Green
: Licensing Unit
PO Box 57, Civic
Centre
Silver Street, Enfield,
Middx EN1 3XH
E-mail : licensing@enfield.gov.uk
Phone : 020 8379 3578
Textphone : 020 8379 4419
Fax : 020 8379 2190
My Ref : LN/201500172
Your Ref : NOT PROVIDED
Date : 27th May 2015

Dear Ms Ezgi Bolat

Licensing Act 2003

Premises : News & Chews, 10 Colman Parade, Southbury Road, ENFIELD, EN1 1YY

This letter concerns the application for a New Application Premises Licence under the Licensing Act 2003.

Please find the licence enclosed. Please check the details on the licence carefully, the Licensing Authority is prepared to correct any of our clerical errors within 28 days of the licence being issued.

Note - Transfers

On the grant of a transfer application, any notification or permit (under the Gambling Act 2005) in respect of gaming machines at the premises becomes null and void. A new notification or permit will need to be sought by the new holder of the premises licence (under the Licensing Act 2003) before gaming machines may be lawfully provided at the premises.

Please be advised that the licence does not override any restrictions on trading hours etc. that may apply to the premises in respect of planning permission and/or Sunday trading & etc.

The terms, conditions and restrictions of the licence must be complied with whenever the premise is used for licensable activities. Failure to comply with the licence is a criminal offence with, on conviction, a maximum fine of £20,000 and/or up to 6 months imprisonment.

The Licensing Enforcement Team advise as follows

In order to support premises in meeting the conditions of their licence, the Licensing Authority has produced material such as training guidance, leave quietly signs, refusals book, which can be found on the Enfield website by following this link:

http://www.enfield.gov.uk/downloads/download/2316/compliance_documents

Please print the material relevant to the conditions and use in accordance with your licence.

Please be advised that a premises licence lapses if the holder of the licence : dies; becomes a person who lacks capacity (within the meaning of the Mental Capacity Act 2005) to hold the licence; becomes insolvent; is dissolved; or if it is a club, ceases to be a recognised club. An individual becomes insolvent on : the approval of a voluntary arrangement proposed by him; being adjudged bankrupt or having his estate sequestrated; or entering into a deed of arrangement made for the benefit of his creditors or a trust deed for his creditors. A company becomes insolvent on : the approval of a voluntary arrangement proposed by its directors; the appointment of an administrator in respect of the company; the appointment of an administrative receiver in respect of the company; or going into liquidation.

The licence, or a certified copy of it, must be kept on the premises at all times and must be produced on request to any authorised officer. The summary of the licence must be prominently displayed within the premises.

The London Fire Brigade advise as follows :

The issue of capacity should be addressed in the fire risk assessment for the premises use. This does not mean that every premises must have a capacity figure. There should be evidence however that the responsible person has considered the number of persons who can be safely evacuated through the available exits.

A safe capacity figure will be expected in the following circumstances:

- (1) in premises that could potentially become overcrowded; for example bars, pubs, clubs, and other places of public assembly :
- (2) where an engineered solution or BS 9999 has been used to increase capacity;
- (3) where capacity is risk-critical; for example where the premises use has a higher occupancy factor than that which the building was designed for.

Where applicable, capacity should normally be inclusive of staff and performers. Management should be able to demonstrate a realistic method of controlling capacity.

Should you wish to change the operation of the premises in the future by adding new licensable activities or by changing the hours or removing conditions then you will need to apply for a variation of the licence. Please contact us for further advice.

You must notify the licensing authority of any change in the name and/or address of either the premises licence holder or the designated premises supervisor.

The licence is subject to an annual fee, payable on each anniversary of the licence first being granted.

Please be advised that if you are playing music in your business – to staff or customers – it is a legal requirement to obtain permission from the copyright holders. Two organisations exist to help make sure you are correctly licensed to play the music you want. PPL collects royalties on behalf of performers and record companies. PRS for Music collects royalties on behalf of songwriters, composers and music publishers. In most instances, a licence from both organisations is needed to ensure all copyright holders are correctly paid for the use of their music. If you play music in your business, please contact PPL and PRS for Music to obtain the right licences for you. Please visit ppluk.com and prsformusic.com for more information on music licensing or call PPL on 020 7534 1095 and PRS for Music on 0800 068 4828.

All employers have a responsibility to prevent illegal migrant working in the UK. Failure to comply could lead to a penalty of up to £10,000 per illegal worker. Home Office guidance is available at www.ukba.homeoffice.gov.uk/employers/preventillegalworking/

If you require any further information, please do not hesitate to contact me.

Yours sincerely

A handwritten signature in black ink, appearing to read 'EG', with a long horizontal stroke extending to the right.

Ellie Green
Principal Licensing Officer

Licensing Act 2003

PART A – PREMISES LICENCE

Granted by the London Borough of Enfield as Licensing Authority

Premises Licence Number : **LN/201500172**

Part 1 – Premises Details

Postal address of premises :

Premises name : **News & Chews**

Telephone number : **020 3745 6500**

Address : **10 Colman Parade Southbury Road ENFIELD EN1 1YY**

Where the licence is time-limited, the dates : **Not time limited**

The opening hours of the premises, the licensable activities authorised by the licence and the times the licence authorises the carrying out of those activities :

(1) **Open to the Public - Whole premises**

Sunday :	06:00 - 23:00
Monday :	06:00 - 23:00
Tuesday :	06:00 - 23:00
Wednesday :	06:00 - 23:00
Thursday :	06:00 - 23:00
Friday :	07:00 - 00:00
Saturday :	07:00 - 00:00

(2) **Supply of Alcohol - Off supplies**

Sunday :	08:00 - 23:00
Monday :	08:00 - 23:00
Tuesday :	08:00 - 23:00
Wednesday :	08:00 - 23:00
Thursday :	08:00 - 23:00
Friday :	08:00 - 00:00
Saturday :	08:00 - 00:00

Part 2

Name and (registered) address of holder of premises licence :

Name : Gokhan Surensay

Telephone number : 020 3745 6500

e-mail : Not provided

Address : 40 Hoe Lane, ENFIELD, EN3 5SL

Registered number of holder (where applicable) :

Not applicable

Name and (registered) address of second holder of premises licence (where applicable) :

Name : Not applicable

Telephone number :

Address :

Name and address of designated premises supervisor (where the licence authorises the supply of alcohol) :

Name : Gokhan Surensay

Telephone number : 020 3745 6500

e-mail : Not provided

Address : 40 Hoe Lane, ENFIELD, EN3 5SL

Personal licence number and issuing authority of personal licence held by designated premises supervisor (where the licence authorises the supply of alcohol) :

Personal Licence Number : LN/200700220

Issuing Authority : London Borough of Enfield

Premises Licence LN/201500172 was first granted on 27th May 2015.

Signed : 

Date : 27th May 2015

for and on behalf of the

London Borough of Enfield

Licensing Unit, Civic Centre, Silver Street, Enfield EN1 3XH

Telephone : 020 8379 3578



Annex 1 - Mandatory Conditions

- 1. No supply of alcohol may be made under the premises licence : (a) At a time when there is no designated premises supervisor in respect of the premises licence; or (b) At a time when the designated premises supervisor does not hold a personal licence or his personal licence is suspended.**
- 2. Every supply of alcohol under the premises licence must be made or authorised by a person who holds a personal licence.**

Annex 2 - Conditions consistent with the Operating Schedule

- 3. There shall be no adult entertainment or services, activities or matters ancillary to the use of the premises that may give rise to concern in respect of children.**
- 4. All staff shall receive induction and refresher training (at least every three months) relating to the sale of alcohol and the times and conditions of the premises licence.**
- 5. All training relating to the sale of alcohol and the times and conditions of the premises licence shall be documented and records kept at the premises. These records shall be made available to the Police and/or Local Authority upon request and shall be kept for at least one year.**
- 6. A 'Think 25' proof of age scheme shall be operated and relevant material shall be displayed at the premises.**
- 7. A written record of refused sales shall be kept on the premises and completed when necessary. This record shall be made available to Police and/or the Local Authority upon request and shall be kept for at least one year from the date of the last entry.**
- 8. Prominent, clear and legible notices shall be displayed at all public exits from the premises requesting customers respect the needs of local residents and leave the premises and area quietly. These notices shall be positioned at eye level and in a location where those leaving the premises can read them.**
- 9. A digital CCTV system must be installed in the premises complying with the following criteria:**
 - (1) Cameras must be sited to observe the entrance and exit doors both inside and outside, the alcohol displays, and floor areas.**
 - (2) Cameras on the entrances must capture full frame shots of the heads and shoulders of all people entering the premises i.e. capable of identification.**
 - (3) Cameras overlooking floor areas should be wide angled to give an overview of the premises.**
 - (4) Provide a linked record of the date, time, and place of any image.**
 - (5) Provide good quality images.**
 - (6) Operate under existing light levels within and outside the premises.**
 - (7) Have the recording device located in a secure area or locked cabinet.**
 - (8) Have a monitor to review images and recorded picture quality.**

- (9) Be regularly maintained to ensure continuous quality of image capture and retention.**
- (10) Have signage displayed in the customer area to advise that CCTV is in operation.**
- (11) Digital images must be kept for 31 days.**
- (12) Police or authorised local authority employees will have access to images at any reasonable time.**
- (13) The equipment must have a suitable export method, e.g. CD/DVD writer so that the police can make an evidential copy of the data they require. This data should be in the native file format, to ensure that no image quality is lost when making the copy. If this format is non-standard (i.e. manufacturer proprietary) then the manufacturer should supply the replay software to ensure that the video on the CD can be replayed by the police on a standard computer. Copies must be made available to Police or authorised local authority employees on request.**

10. Signs shall be prominently displayed on the exit doors advising customers that the premises is in a 'Designated Public Place Order' and that alcohol should not be taken off the premises and consumed in the street. These notices shall be positioned at eye level and in a location where those leaving the premises can read them.

Annex 3 - Conditions attached after a hearing by the Licensing Authority

Not applicable

Annex 4 – Plans

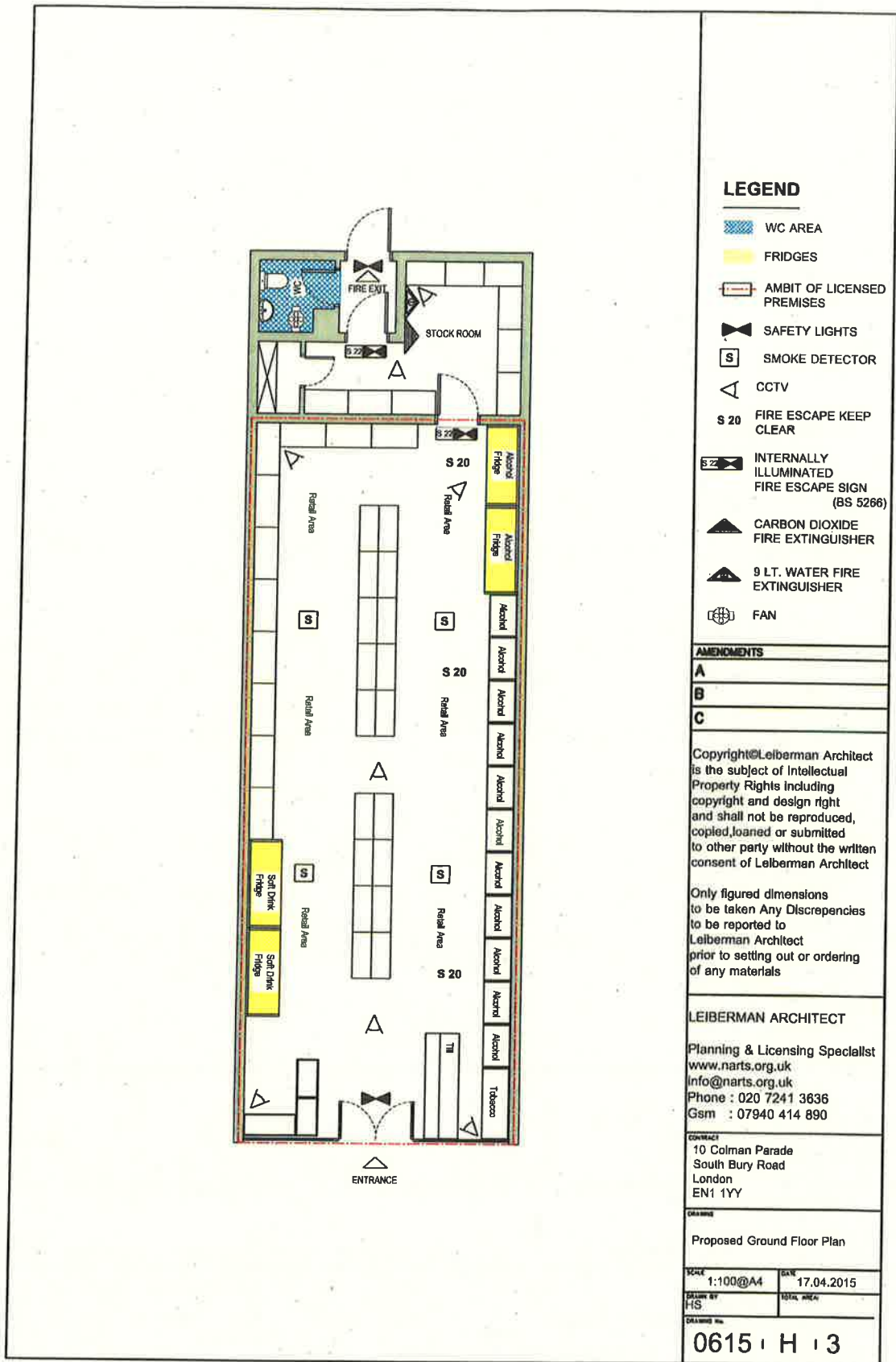

PART B – PREMISES LICENCE SUMMARY

Granted by the London Borough of Enfield as Licensing Authority

Premises Licence Number : **LN/201500172**

Part 1 – Premises Details

Postal address of premises :

Premises name : **News & Chews**

Telephone number : **020 3745 6500**

Address : **10 Colman Parade Southbury Road ENFIELD EN1 1YY**

Where the licence is time-limited, the dates : **Not time limited**

The opening hours of the premises, the licensable activities authorised by the licence and the times the licence authorises the carrying out of those activities :

(1) Open to the Public - Whole premises

Sunday :	06:00 - 23:00
Monday :	06:00 - 23:00
Tuesday :	06:00 - 23:00
Wednesday :	06:00 - 23:00
Thursday :	06:00 - 23:00
Friday :	07:00 - 00:00
Saturday :	07:00 - 00:00

(2) Supply of Alcohol - Off supplies

Sunday :	08:00 - 23:00
Monday :	08:00 - 23:00
Tuesday :	08:00 - 23:00
Wednesday :	08:00 - 23:00
Thursday :	08:00 - 23:00
Friday :	08:00 - 00:00
Saturday :	08:00 - 00:00

Part 2

Name and (registered) address of holder of premises licence :

Name : Gokhan Surensay

Address : 40 Hoe Lane, ENFIELD, EN3 5SL

Registered number of holder (where applicable) :

Not applicable

Name and (registered) address of second holder of premises licence (where applicable) :

Name : Not applicable

Address :

Name of designated premises supervisor (where the licence authorises the supply of alcohol) :

Gokhan Surensay

State whether access to the premises by children is restricted/prohibited :

Not Restricted

Premises Licence LN/201500172 was first granted on 27th May 2015.

Date : 27th May 2015

London Borough of Enfield
Licensing Unit, Civic Centre, Silver Street, Enfield EN1 3XH
Telephone : 020 8379 3578

